

D1 Dimmer -No. 5520

DESCRIPTION

The D1 is a high output single channel low voltage dimmer. Ideal for LED tape applications, its 15A output capacity is perfect for use with extended runs of 12V or 24V single color tape. Its small size makes it ideal for mounting behind scenery, displays, and in cabinetry. Use it directly connected to any DMX compatible controller/console or in conjunction

with one of our wireless DMX transmitter/receiver systems. The device has four dimming modes: *Linear* and *ISL* for incandescent use, *Non-Dim* (on/off) -for relays, solenoids etc., and *LED* for use with tape. 12-24VDC 15A max input. 15A max output per channel, 15A max output per dimmer.

FEATURES & COMPONENT IDENTIFICATION

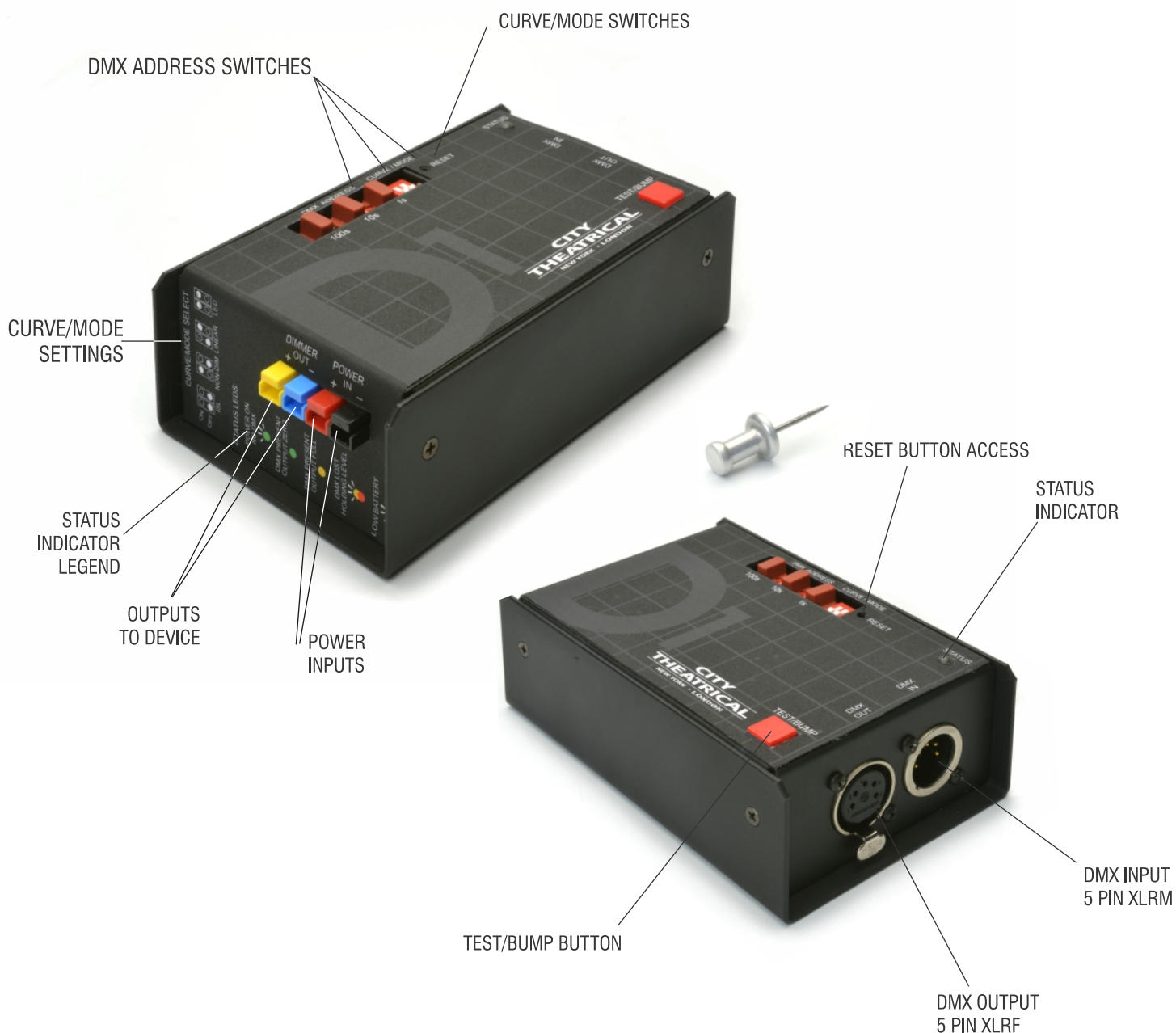

SETUP SCHEMATIC- SINGLE COLOR LED TAPE

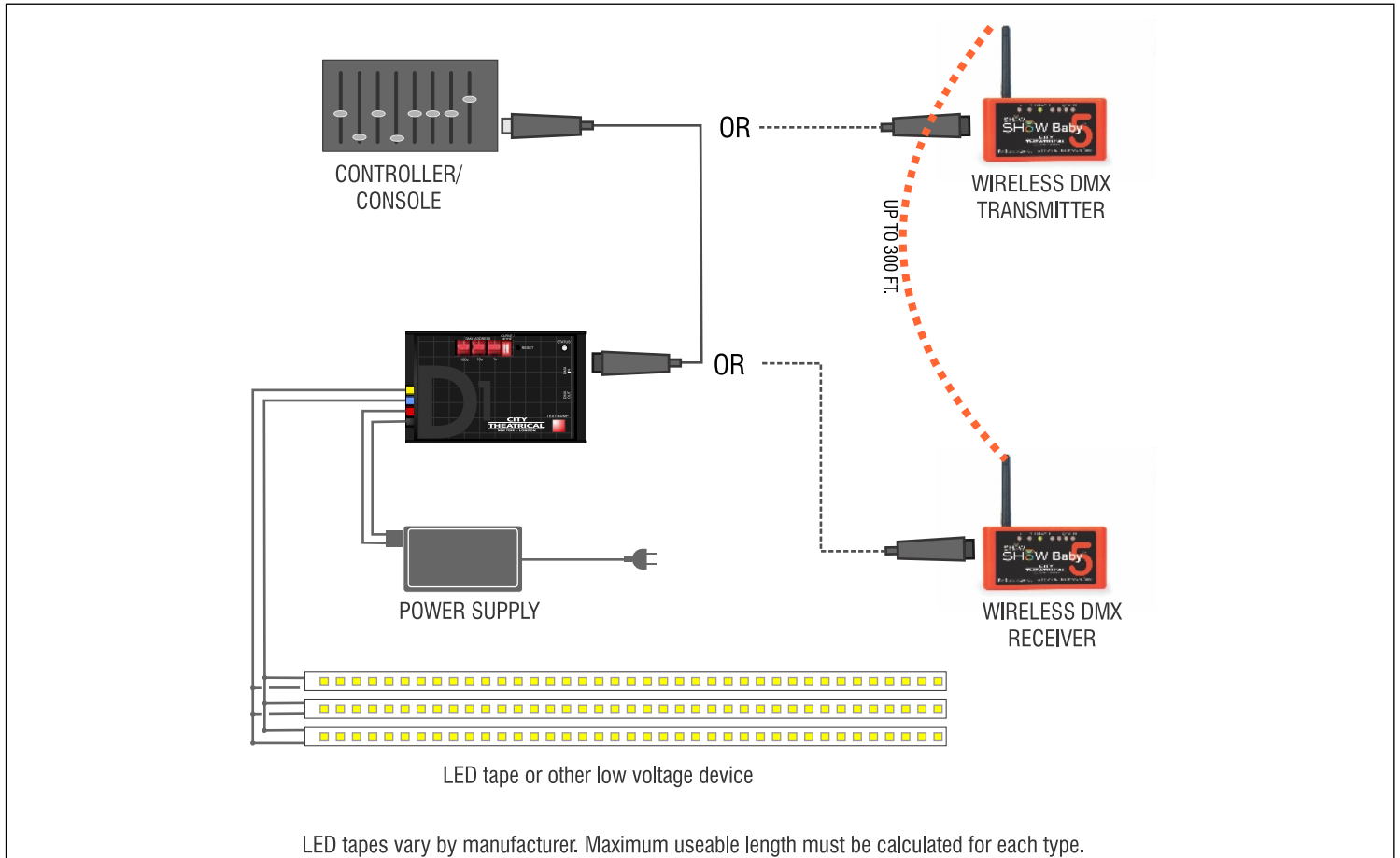

SPECIFICATIONS

Power

- 1 Channel (15A)
- 12V- 180 Watts max
- 24V- 360 Watts max

Features

- DMX 512 Input with Neutrik 5 pin XLR male connector
- Isolated and repeated DMX512 Pass-Through with Neutrik 5 pin XLR female connector
- Automatic DMX termination
- DMX Starting Address: any DMX address 1 – 512, configured with (3) standard BCD switches
- Four Dimming Curves
 - ISL
 - Linear
 - Non-dim
 - LED
- Bump button for load test
- Status LEDs for Power, DMX, and output functions

Connections

- Color-coded Anderson 30A Powerpole power and load connectors

Mechanical

- NEMA 1 enclosure, Steel

Compliance

- ETL Listed, CE Certified, RoHS Compliant

WHATS IN THE BOX:

D1 unit
User manual

ADDITIONAL REQUIRED COMPONENTS:

Controller/console
Power supply
DMX cable
30A Anderson connectors

RECOMMENDED ACCESSORIES:

Wireless Transceiver:
SHoW DMX Neo / SHoW Baby 5